

Datakey Electronics large memory capacity serial flash memory Keys feature a Serial Peripheral Interface (SPI)¹ which is a synchronous serial data link that is standard across many microprocessors and other peripheral chips. It provides a high bandwidth network connection among CPUs and other devices supporting the SPI-compatible bus. The primary applications are data logging, firmware updates, and data transfer. From 1 to 256 bytes may be written to the memory using the Page Programming instruction. The entire contents of memory may be read using a single Read instruction. Refer to the Memory SPI Interface Specification for specific sector and page information. The SFK 5V Series features 5 volt Vcc and logic operation, and Datakey Electronics' industry-leading solid molded construction, rugged wear-resistant exterior and long-lasting contacts. **The SFK 5V Series is recommended only for applications requiring 5 volt operation. For all other applications, use the standard SFK Series (3.3 volt).**

Mechanical	
Contact Life	15,000 Insertions/Removal Cycles Min.
Contact Arrangement	Fully Redundant (Top:Bottom)
Key Head Shear Limit	15 Pounds
Key Twist Torque Limit	15 Inch-pounds
Electrical ¹	
Power, Active	130 mW (Chip Erase) 80 mW (Read)
Power, Standby	5 mW typical
Voltage	5.0V
ESD Protection	10kV (per Std. 064-1028)
Environmental	
Storage Temperature	-40° C to + 100° C
Operating Temperature	-40° C to + 85° C
Relative Humidity	5% to 95% (non-condensing)
Memory ¹	
Key:	Capacity:
SFK5V1Mb	1,048,576 bits (131,072 bytes)
SFK5V2Mb	2,097,152 bits (262,144 bytes)
SFK5V4Mb	4,194,304 bits (524,288 bytes)
SFK5V8Mb	8,388,608 bits (1,048,576 bytes)
Read Cycles	Unlimited
Write/Erase Cycles	100,000 Cycles Minimum
Data Life (Storage)	20 Year Data Retention
Mating Component(s)	
Panel-Mount Receptacle	KC4210
PCB Mount Receptacle	KC4210PCB
Reader/Writer	KeyLink™ III (recommended), KeyLink™ II
Ordering Information ²	
SFK5V1Mb	611-0146-00XA
SFK5V2Mb	611-0105-00XA
SFK5V4Mb	611-0147-00XA
SFK5V8Mb	611-0130-00XA

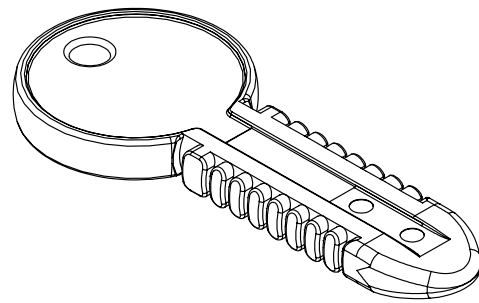

Refer to Keyceptacle® data sheets for pin-out information. Other Key head designs and customization are also available. Contact factory.

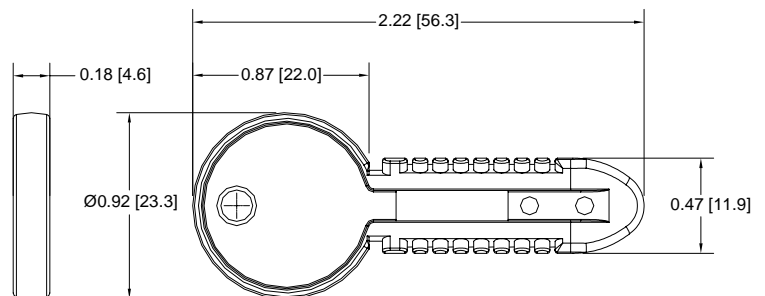

Drawing dimensions are in inches and millimeters [mm]. Dimensions are nominal and subject to manufacturer's tolerances.

NOTES:

- 1: Complete SPI Interface Specification available at http://www.datakeyelectronics.com/technical_inter_specs.html
- 2: "X" indicates optional color number. "A" suffix on part number indicates RoHS compliance.

