

Datakey Electronics' IIX Series of Extended Tokens provide security-enhanced data storage and transfer for end-user applications. Each IIX Token contains a non-volatile, serial I²C¹ EEPROM that can be read, erased, and written to via a receptacle (which is available in panel-mount and multiple board-mount forms) or the SlimLink™ Reader/Writers. The EEPROM in the IIX Token has a unique factory-embedded serial number that cannot be changed by the user. The unique serial number can be used to prevent duplication of Tokens by using the serial number as a unique encryption seed or by having the host system store a list of authorized serial numbers. A solid-molded, synthetic body protects the embedded memory from harsh environmental influences, so it retains data even when exposed to dirt, moisture, chemicals, X-rays, and up to 15kV of electrostatic discharge.

Mechanical	
Contact Life	10,000 Insertions/Removal Cycles Min.
Contact Arrangement	Fully Redundant (Front:Back)
Electrical ¹	
Power, Active	25 milliwatts typical at 5.0V (max)
Power, Standby	100 microwatts typical at 5.0V (max.)
Voltage ²	2.7 to 5.5V
ESD Protection	15kV (per Std. 064-1028)
Environmental	
Storage Temperature	-40° C to + 100° C
Operating Temperature	-40° C to + 85° C
Relative Humidity	5% to 95% (non-condensing)
Memory ¹	
Extended Token:	Capacity:
IIX	1536 bits (192 bytes)
Read Cycles	Unlimited
Write/Erase Cycles	100,000 Cycles Minimum
Data Life (Storage)	10 Years Minimum
Mating Component(s)	
Panel-Mount Receptacle	SR4210
PCB Mount Receptacle	SR4000 Family of Receptacles
Reader/Writers	SlimLink™ III (recommended); SlimLink™ II
Ordering Information	
IIX Series	Consult factory.

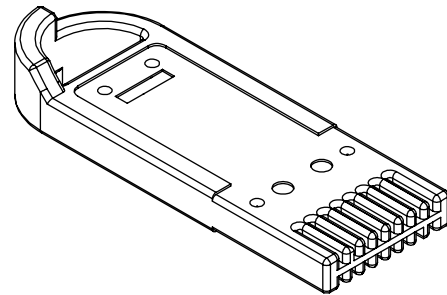

For pin-out information, refer to the individual data sheets for the SR4000 Family of Receptacles.

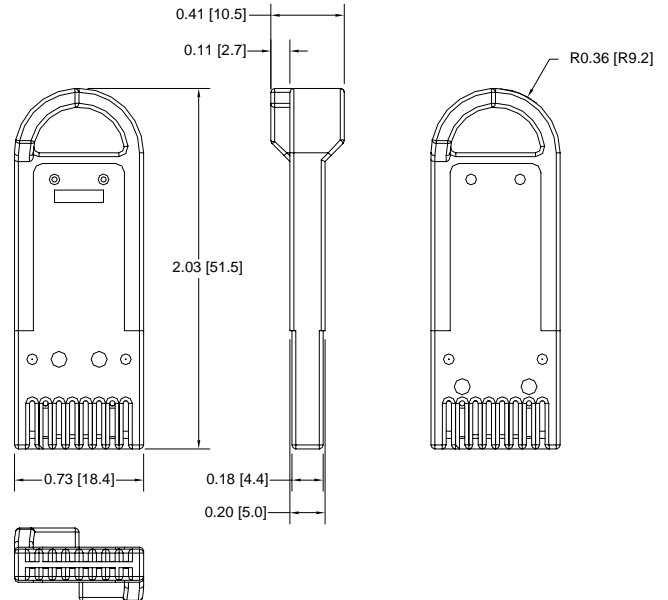

NOTES:

- Complete I²C Interface Specification available at: http://www.datakeyelectronics.com/technical_inter_specs.html
- Design Recommendation:** It is recommended that all new Key/Token implementations be designed to operate with power supplies in the range of 2.7 to 3.6 volts. Although there is no immediate or certain future difficulties in the procurement of memory devices that operate with V_{cc} in the 4.5 to 5.5 volt range, it is possible the future availability of such memories may be impacted as semiconductor manufacturers continue to shrink their die geometries. Please contact the factory if you have any questions pertaining to this with your current or legacy design.

Drawing dimensions are in inches and millimeters [mm]. Dimensions are nominal and subject to manufacturer's tolerances.

